

# TAG RACING INTERNATIONAL™

Manufacturer Address  
Tongqin Donggan,  
Fenghuang Hill Industrial Base,  
Wuyi, Zhejiang,  
CHINA 311200

Engine #

Manufacturer	Shengqi Motion Apparatus Co., Ltd
Make	Cheetah
Model	SQ 125
Inlet type	Reed
Number of pages	10

## PICTURES OF ENGINE

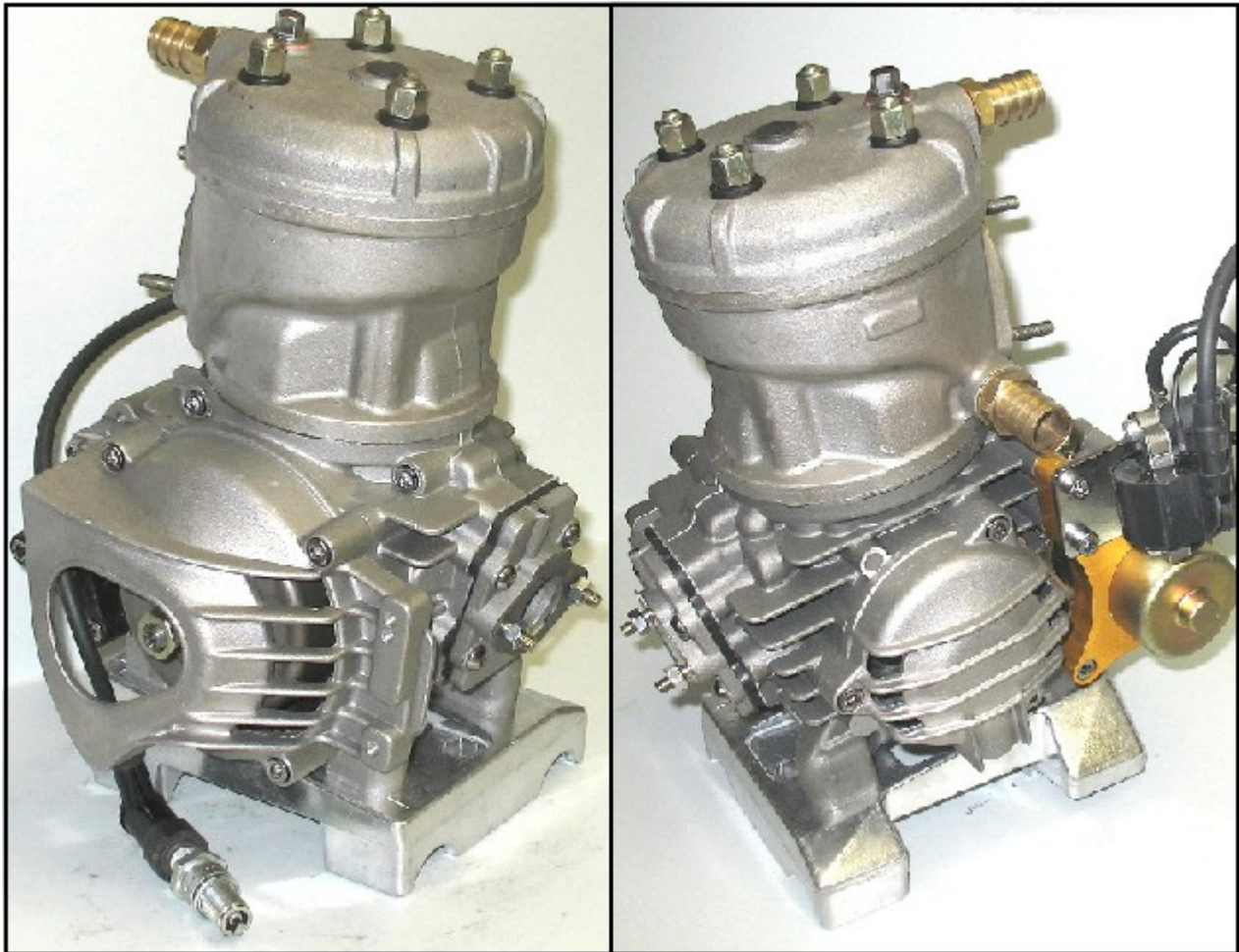

TAG Racing International™

Engine Specification Sheet



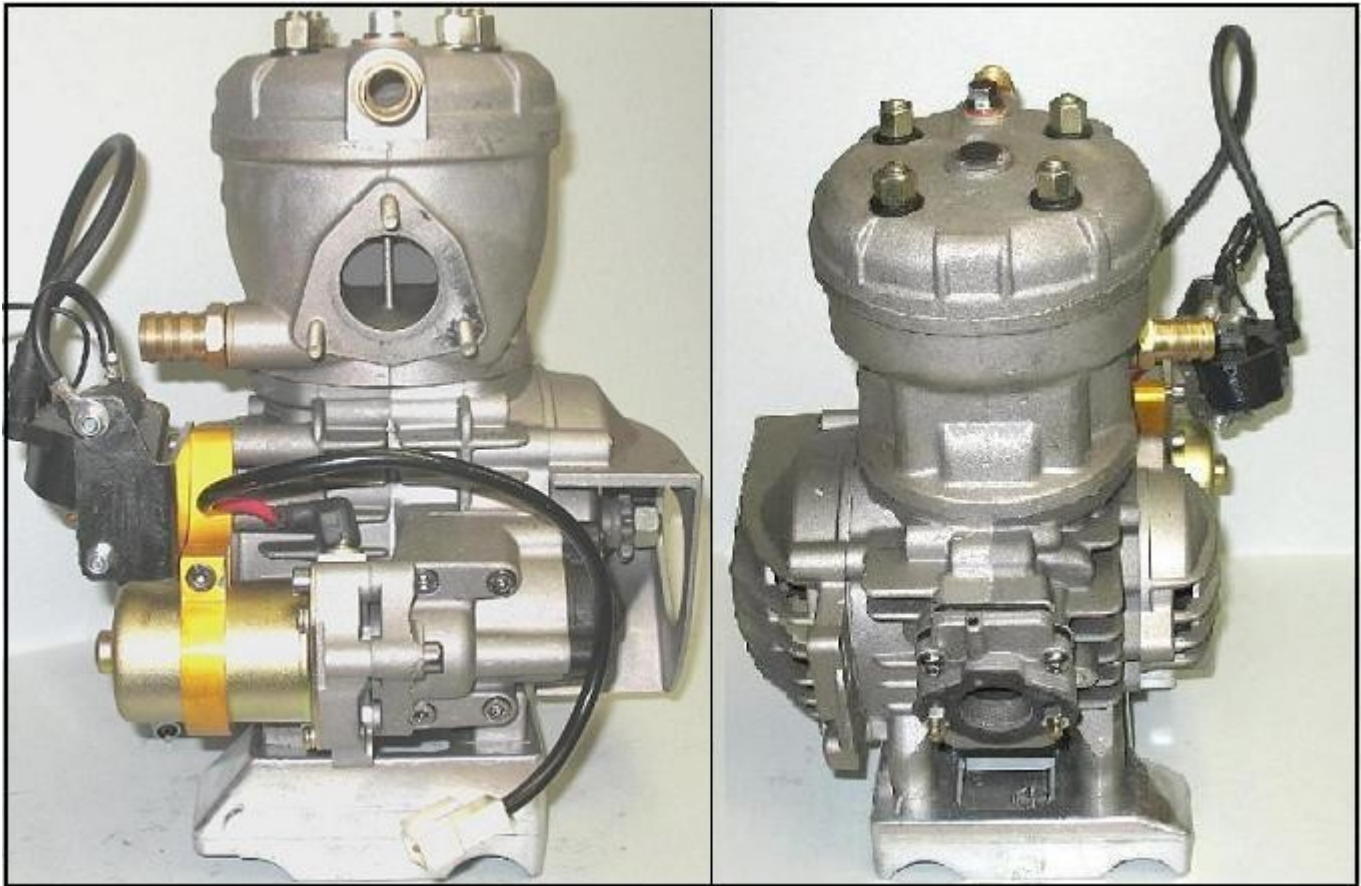

**Signature and Stamp**

--	--	--

Importer	SQ MOTORSPORTS	TORONTO, ONTARIO, CANADA
----------	----------------	--------------------------

*TAG Racing International™*  
 Engine Specification Sheet

**TECHNICAL INFORMATION**

A	<b>CHARACTERISTICS</b>	
	Measurement	Tolerances

Volume of cylinder	125.00 cc.	MAXIMUM
Original bore	54 mm.	
Theoretical maximum bore	54.28 mm.	
Stroke	54 mm.	
Cooling system	Water	
Number of carburation systems	1	
Number of transfer ports / ducts	3 ( 2 transfer, 1 boost )	
Number of exhaust ports / ducts	2	
Shape of the combustion chamber	Spherical	
Length between axes of the connecting rod	102 mm.	+/- 0.1mm.
Minimum weight of connecting rod	117 g.	MINIMUM
Volume of combustion chamber	10 cc. LAD, head on engine	MINIMUM
Type of bearings and size	Crankshaft Bearings=6205 ( 25x52x15 ) Big End Rod Brg = 18 X 24 <i>NEEDLE</i> Little End Rod Brg=14 X 18 <i>NEEDLE</i>	

<b>B</b>	<b>OPENING ANGLES</b>	
Exhaust	171	MAXIMUM
Of transfer ports / ducts	126	MAXIMUM
Of boost port / ducts	129	MAXIMUM

<b>C</b>	<b>LIST OF ACCESSORIES INCLUDED</b>	
Battery	Yes	
Centrifugal clutch	Yes	
Carburetor with butterfly Ø23	Yes	

Electric starter	Yes
Exhaust with flex	Yes

<b>D</b>	<b>MATERIAL</b>	
Cylinder	Aluminum alloy, nicasil bore	
Connecting rod	Steel alloy	
Crankshaft	Steel alloy	
Head	Aluminum alloy	
Crankcase	Aluminum alloy	
Piston	Aluminum alloy	
Piston Ring	Steel alloy	



**DRAWING OF THE CYLINDER DEVELOPMENT**

Chord reading

Angular reading

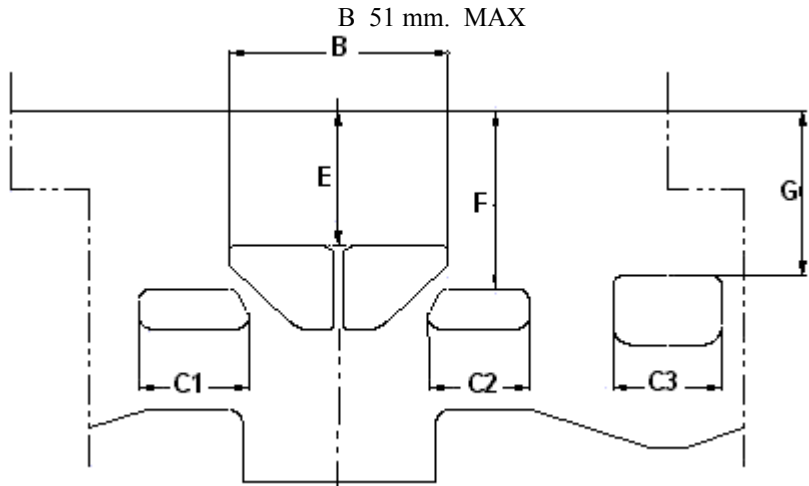

**DRAWING OF THE CYLINDER BASE**

**CYLINDER SECTION VIEW**

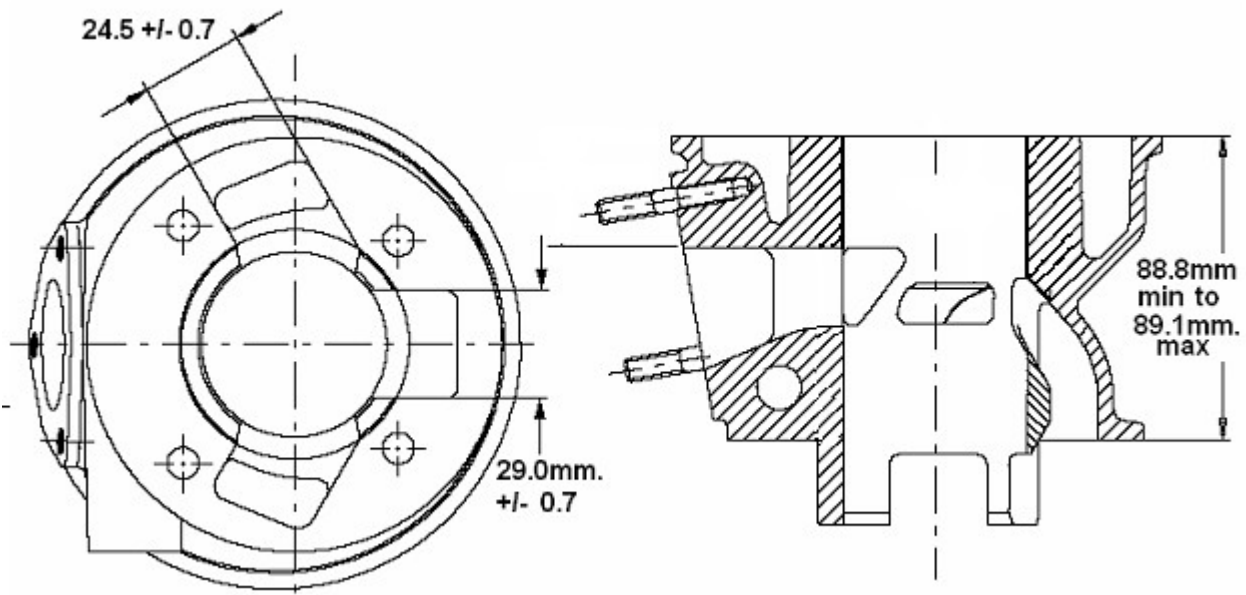

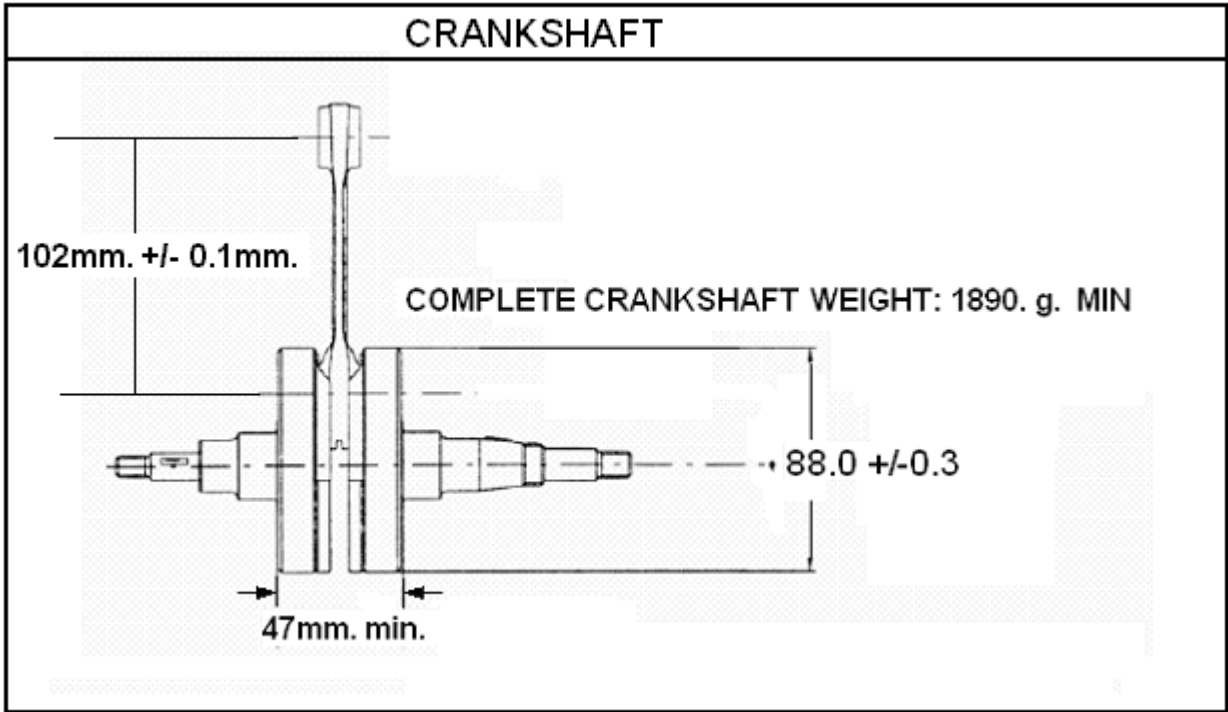
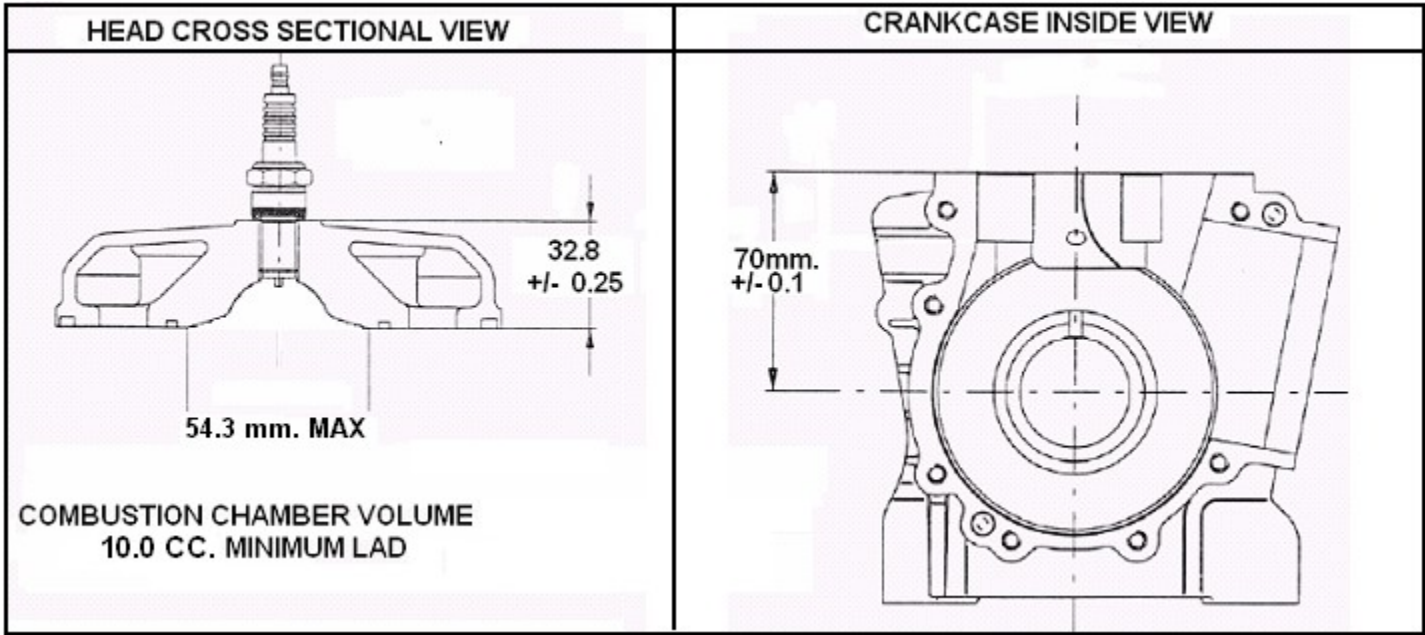

TAG Racing International™

Engine Specification Sheet



# IGNITION

Manufacturer : SQ

Rotation CCW

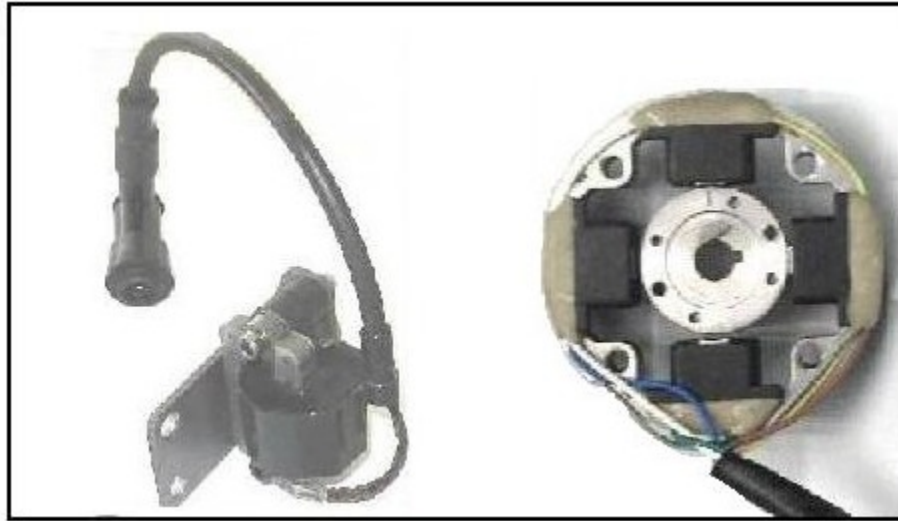

# REED BLOCK, REEDS

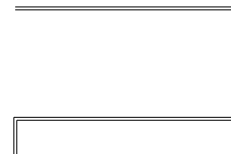
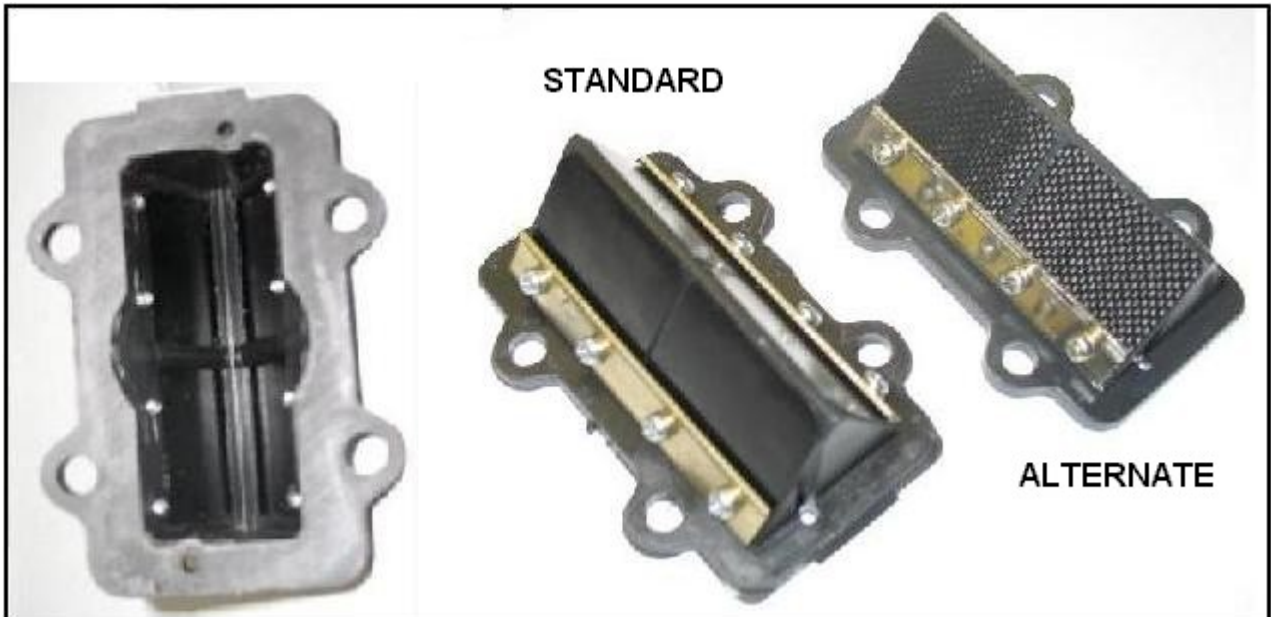

# CARBURETOR DIMENSION

BORE MACHINED COMPARITIVELY BY TILLOTSON ONLY

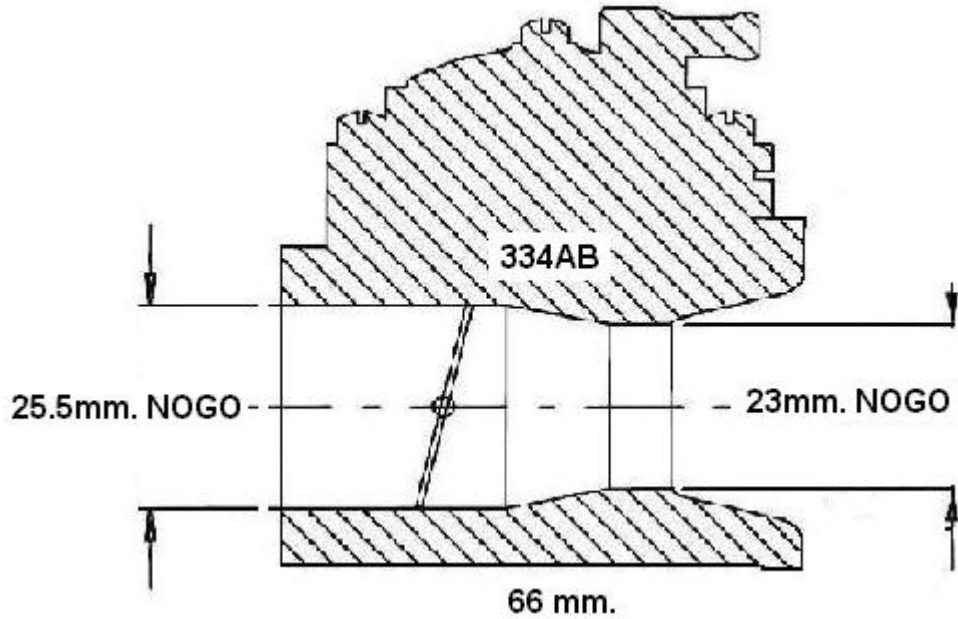

PISTON

CONNECTING ROD

*TAG Racing International™*

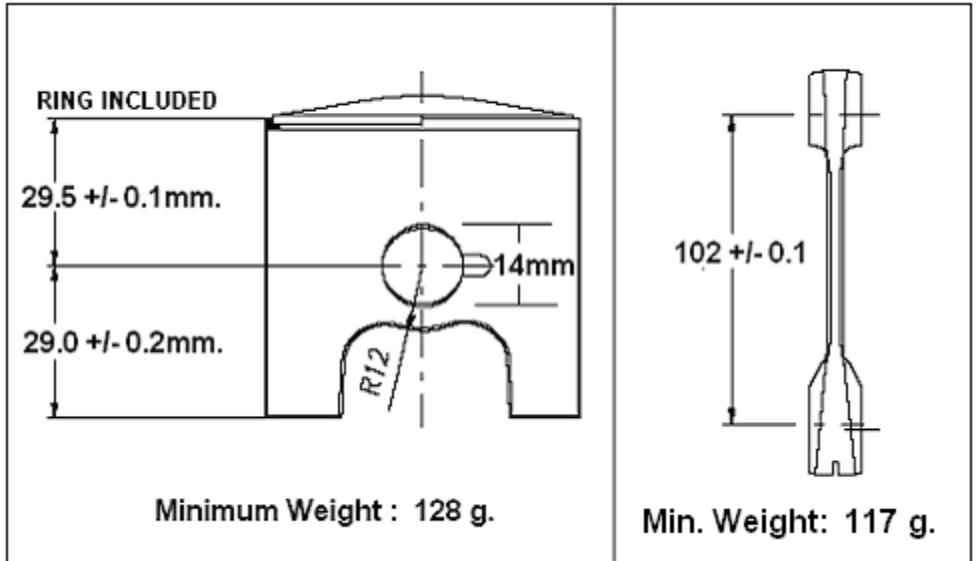

Engine Specification Sheet



## EXPANSION CHAMBER AND MUFFLER DIMENSIONS

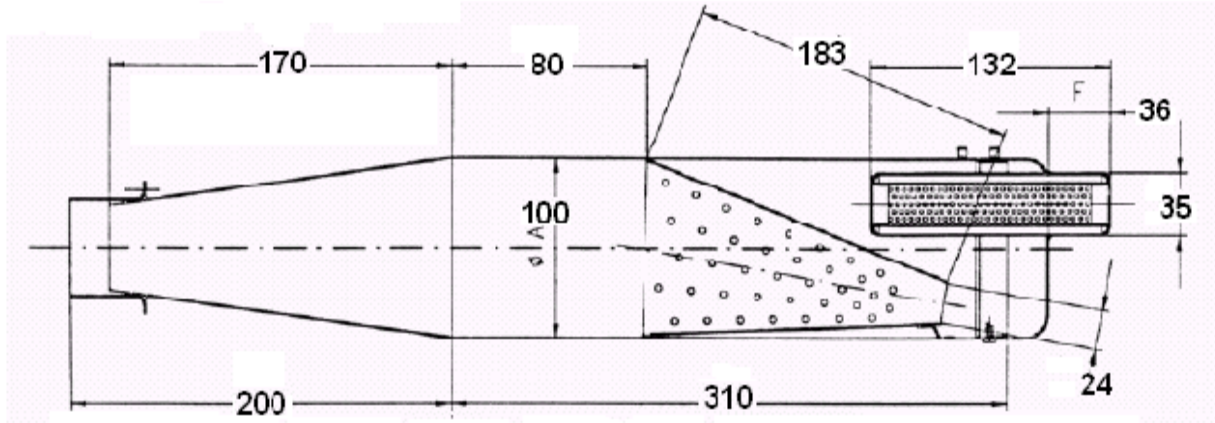

### TOLERANCES

Rough dimensions

up to 25mm → ±1mm

From - to 25-60mm → ±1,5mm

more than 60mm → ±3mm

### DRAWING OF THE SILENCER AND IT'S COMPONENTS

*(Insert drawing here)*



## DRAWING OF THE CLUTCH

**NOTES:**

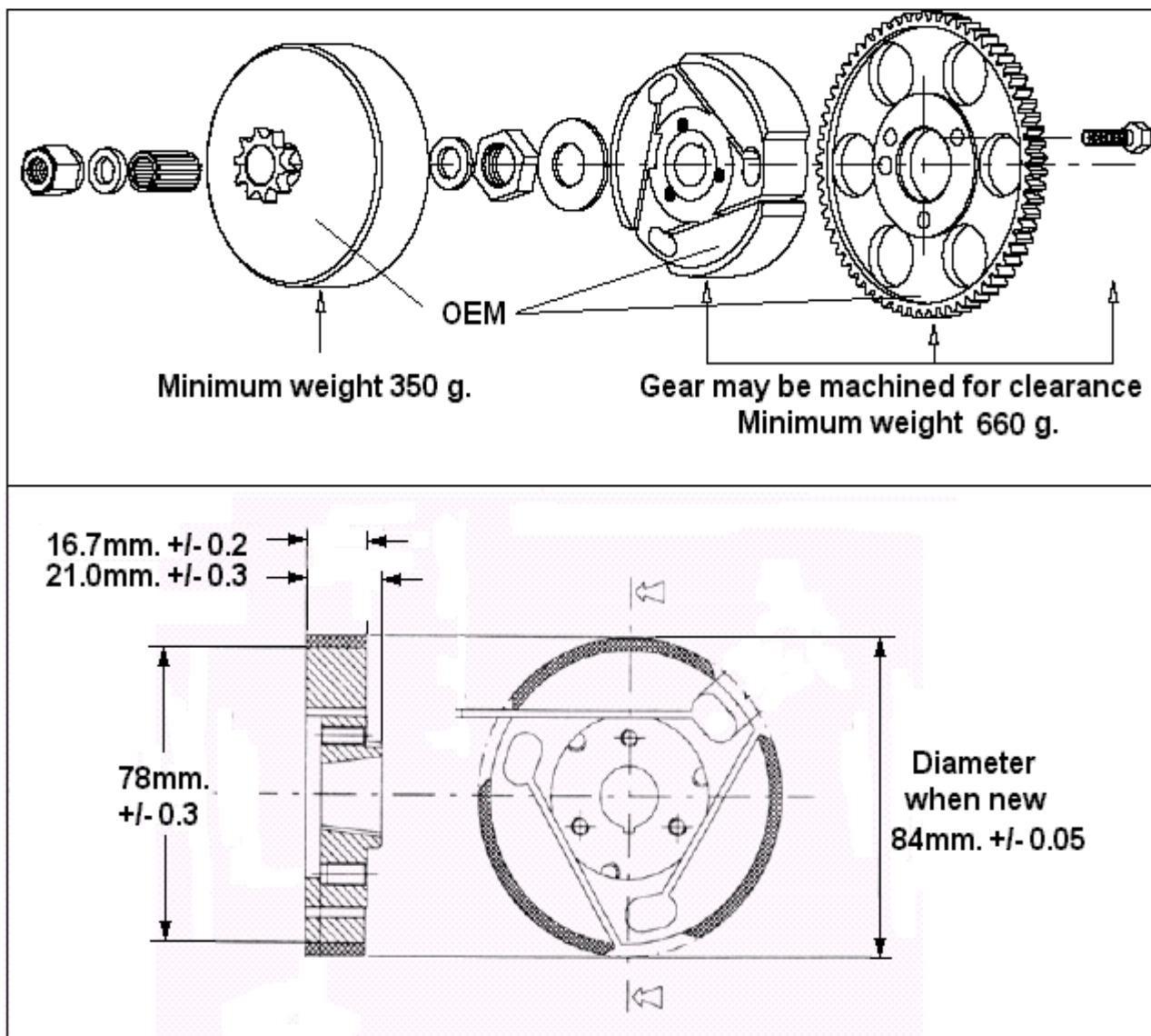

<b>1</b>	General	All parts must remain OEM as supplied by the Manufacturer and be unmodified unless otherwise stated. Unless this document states that you CAN modify any part, you CANNOT. Minor grinding errors in the port/duct areas by the Manufacturer are allowed. Minor port chamfering by the manufacturer before the addition of the Nicasil process is allowed. Minor hand/flat plate cleaning of the top of the cylinder to facilitate proper head sealing is allowed
<b>2</b>	Inlet silencer	OEM
<b>3</b>	Spark plug	NGK "B" or "BR" series
<b>4</b>	Ignition	OEM
<b>5</b>	Battery	OEM

<b>6</b>	Water pump	OEM
<b>7</b>	Piston	OEM – including exhaust bridge lubrication holes
<b>8</b>	NON tech items	Radiator mounting hardware Water hoses and clamps Data acquisition systems and sensors Fasteners – except Carburetor butterfly screw
<b>9</b>	Adjustments	Technical adjustments may be required to these specifications. Approval by TAG Racing International is mandatory before such changes/adjustments are used in competition.